

# GLENMONT, NY

294 Route 9 West

**Ground Lease or Built-to-Suit: 7.17 Acres**



- 7.17 Acres located on US Route 9W in the town of Glenmont, NY
- Located directly across from a Walmart Supercenter and Lowe's
- Highly visible site situated at a lighted intersection
- Ground Lease or Built-to-Suit

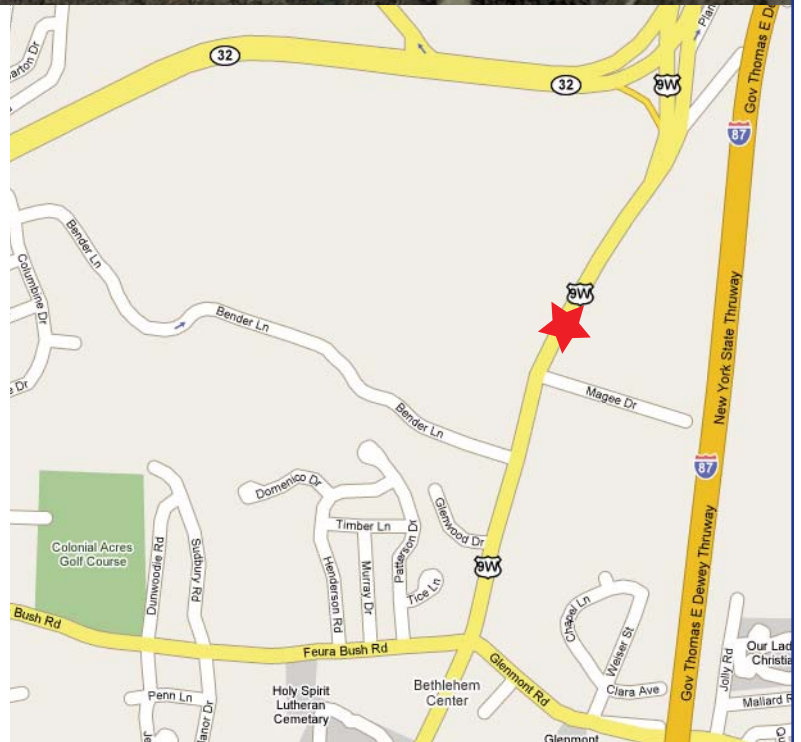

Russell Francis • [rfrancis@atsrealty.com](mailto:rfrancis@atsrealty.com) • 518.731.7510

1601 Trapelo Road, Suite 250 • Waltham, MA 02451 • Phone 781.672.0200 • Fax 781.672.0277 • [www.atsrealty.com](http://www.atsrealty.com)

Information presented herein is from sources deemed reliable. However, no warranty can be made as to the accuracy of this information, which is presented subject to prior sale, rental, or withdrawal from the market without notice.

**ATS**  
▲ ■ ●  
REALTY

# GLENMONT, NY

294 Route 9 West

**Ground Lease or Built-to-Suit: 7.17 Acres**

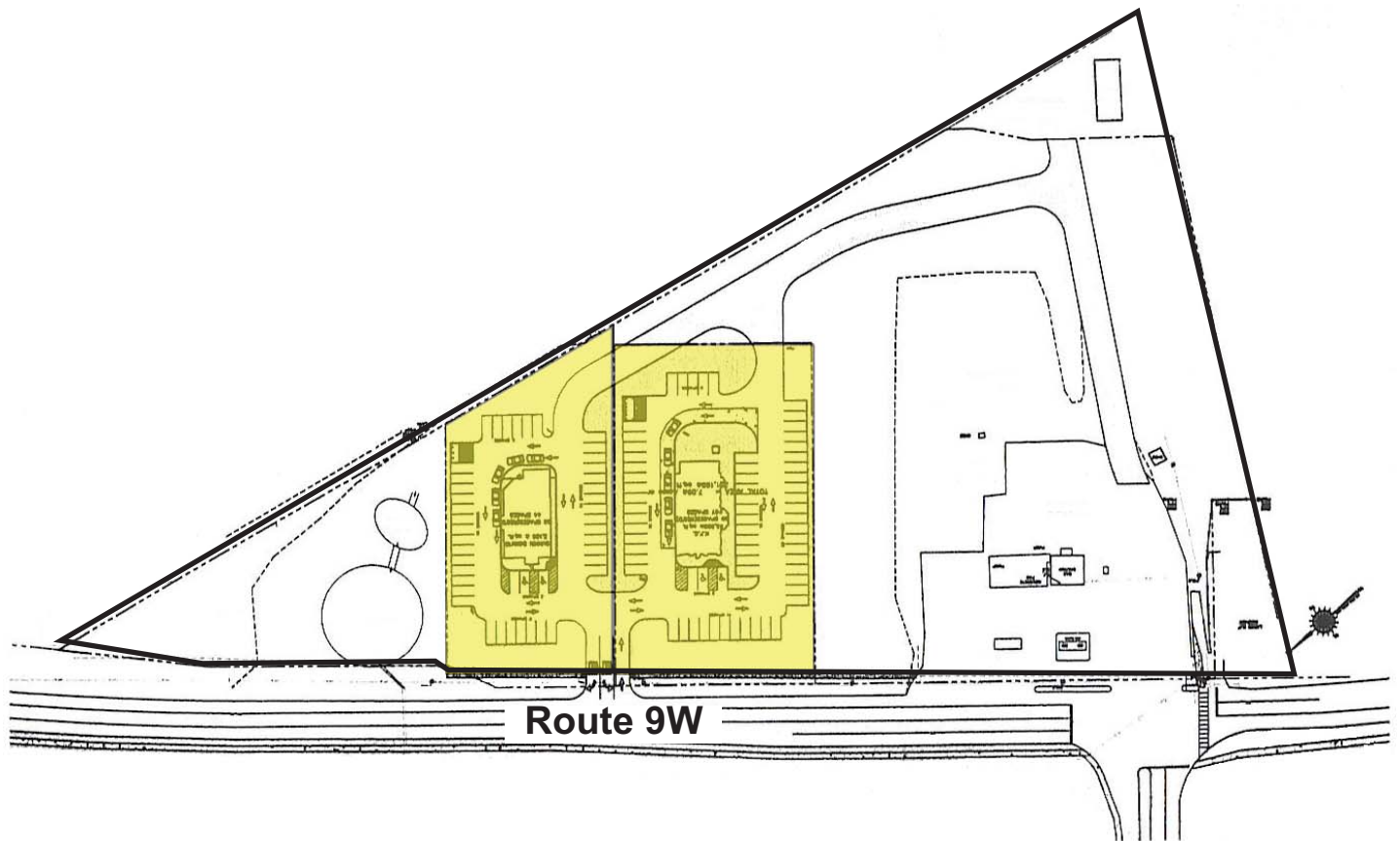

• **Population**

3 mile 29,033  
5 mile 119,497  
7 mile 175,563

• **Avg. HH Income**

3 mile \$76,884  
5 mile \$59,286  
7 mile \$61,023

• **Households**

3 mile 11,727  
5 mile 52,897  
7 mile 75,199

Russell Francis • [rfrancis@atsrealty.com](mailto:rfrancis@atsrealty.com) • 518.731.7510

1601 Trapelo Road, Suite 250 • Waltham, MA 02451 • Phone 781.672.0200 • Fax 781.672.0277 • [www.atsrealty.com](http://www.atsrealty.com)

Information presented herein is from sources deemed reliable. However, no warranty can be made as to the accuracy of this information, which is presented subject to prior sale, rental, or withdrawal from the market without notice.

**ATS**  
▲ ■ ●  
REALTY