

BRANDON, VT

21 Nickerson Road

New Retail Development: up to 60,000 SF



- Future retail development of up to 60,000 SF available for lease
- Located on busy Route 7 with a traffic count of 7,500
- Nearby retailers include Aubuchon Hardware, Rite Aid, Grand Union, First Brandon Bank, and many other local retailers
- Redesign of site plan is possible

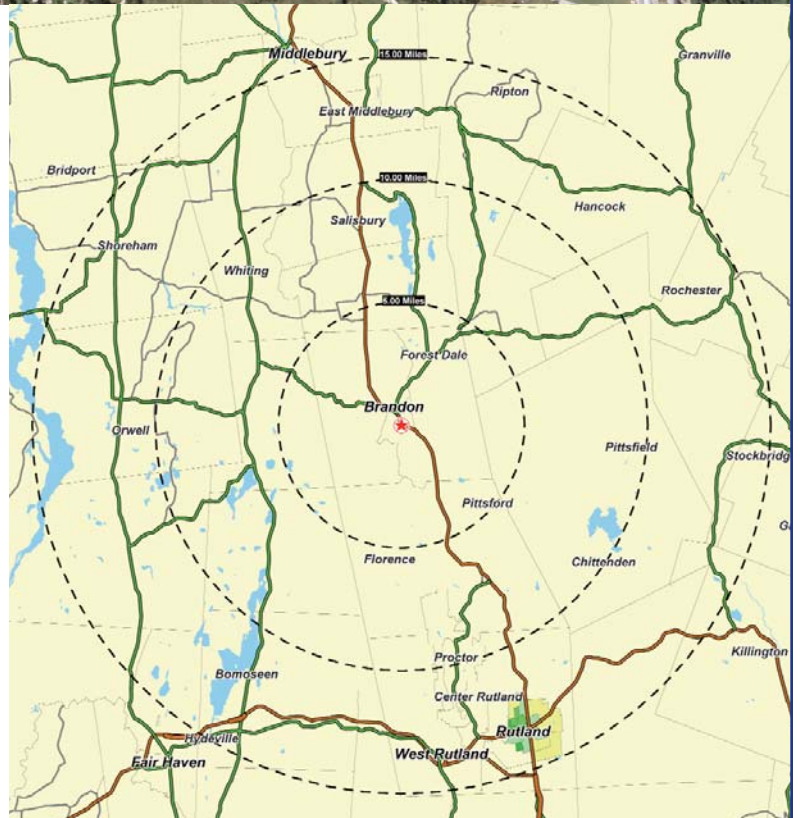

Mark Thibeault • mthibeault@atsrealty.com • 802.879.1410

1601 Trapelo Road, Suite 250 • Waltham, MA 02451 • Phone 781.672.0200 • Fax 781.672.0277 • www.atsrealty.com

ATS
▲ ■ ●
REALTY

BRANDON, VT

21 Nickerson Road

New Retail Development: up to 60,000 SF

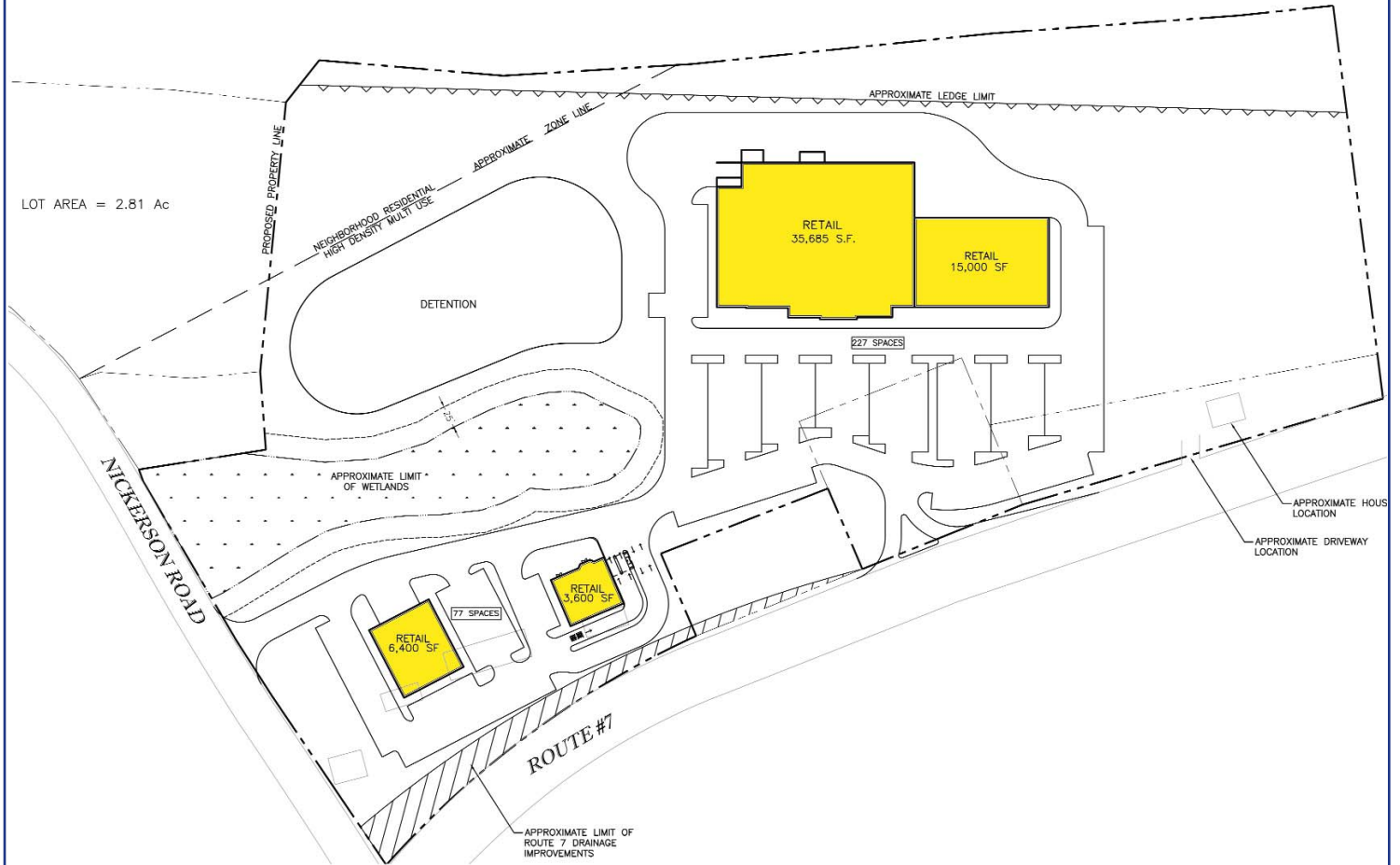

• Population		• Avg. HH Income		• Households		• Daytime Pop.	
5 mile	5,436	5 mile	\$61,489	5 mile	2,866	5 mile	1,620
10 mile	14,323	10 mile	\$60,705	10 mile	5,973	10 mile	3,064
15 mile	52,567	15 mile	\$55,922	15 mile	21,665	15 mile	26,200

Mark Thibeault • mthibeault@atsrealty.com • 802.879.1410

1601 Trapelo Road, Suite 250 • Waltham, MA 02451 • Phone 781.672.0200 • Fax 781.672.0277 • www.atsrealty.com

